

Dimensioni & ingombri

24-50-100 kg

200-300 kg

Min. S = * (senza paracadute)
Min. S = 600 (con paracadute)

* = 130 + CH / 2 (cancello doppia ghigliottina)
* = 400 (porta a battente)

DH = CH - 25

Testata Standard T = CH + I 150
Testata Min. T = CH + 800

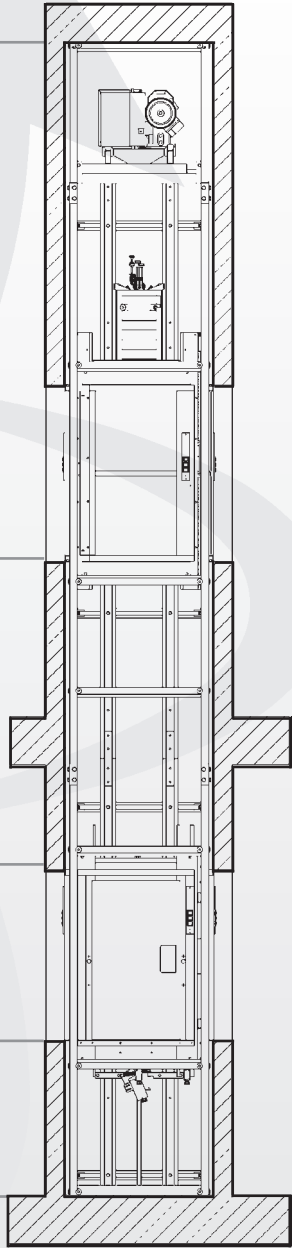

Richiedere fattibilità per quote diverse

Testata Standard T = CH + I 450
Testata Min. T = CH + I 100

DH = CH

Min. S = 400 (senza paracadute)
Min. S = 600 (con paracadute)

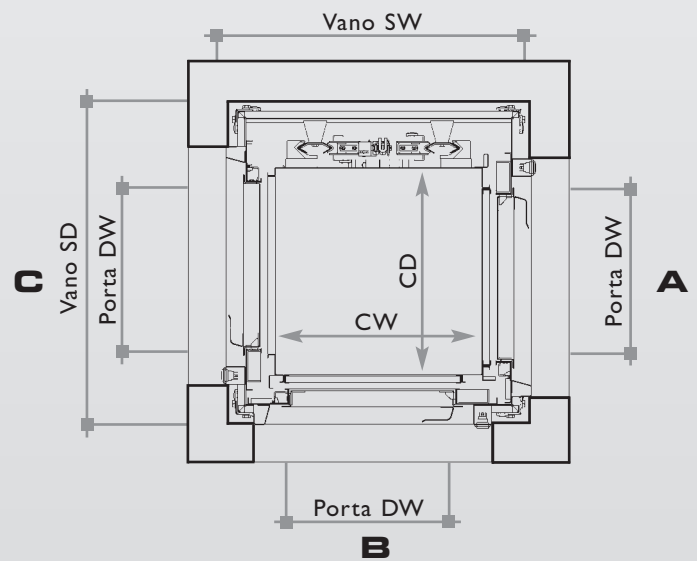
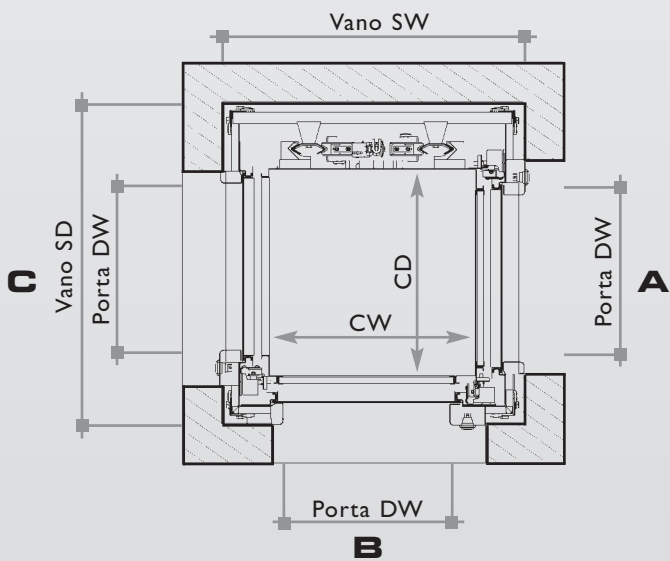
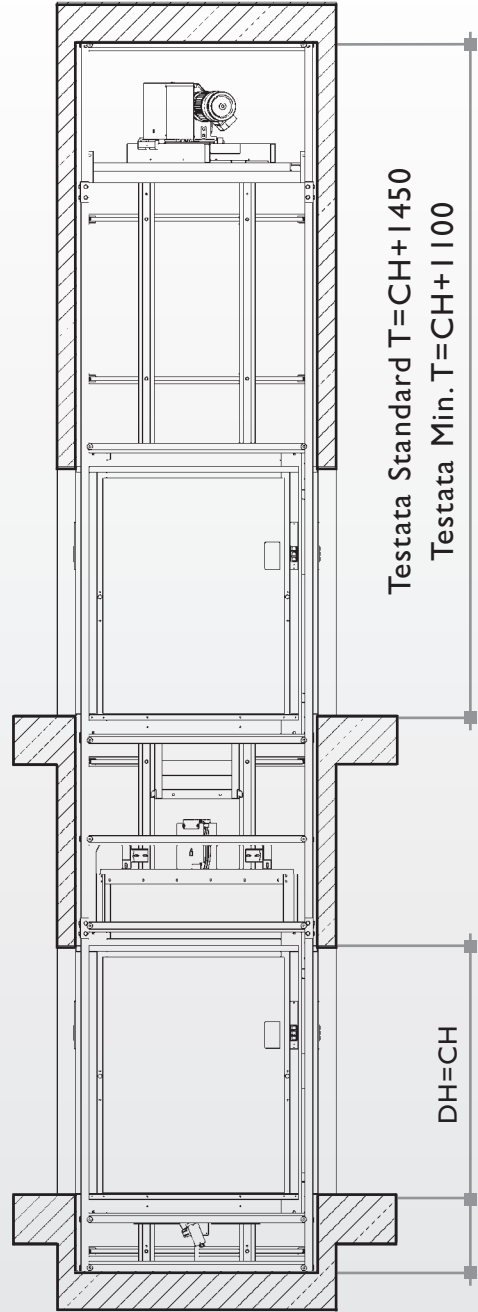

Dimensioni principali (in mm)